



SALTAIRE

ST. PETERSBURG

THE MOST REFINED NEW
ADDRESS ON THE BAYFRONT



Artist's Rendering

PROPERTY OVERVIEW

In the heart of downtown, Saltaire introduces a bold vision for contemporary urban living. At 35 stories, 192 luxury condominium residences and 8,600 sf of retail and dining. Saltaire St. Petersburg is an iconic new address providing street level retail in downtown's bustling restaurant and shopping district.

WITHIN WALKING DISTANCE

- Thousands of Residential Units with many more planned or under construction
- Beach Drive and Central Avenue Shopping and Dining Districts
- Sundial, a premier shopping, dining and movie destination
- Tom James Art museum
- Al Lang Stadium, entertainment venue and home of the Tampa Bay Rowdies
- The Mahaffey Theater performing arts center
- The Dali and MFA Museums
- Albert Whitted Airport
- USF St. Petersburg and St. Petersburg College
- The Saturday Morning Market and approximately 200 vendors and thousands of visitors weekly

- Tropicana Field home of the Tampa Bay Rays
- The Pier

FEATURES

- 8,600 SF +/- Street Level Retail Space
- Retail is supported by Condo development on same block
- Contemporary Urban Design
- Space Divided into 6 condo units
- Typical Bay 29' x 49' for the four Retail units adjacent to 2nd Street and 29' x 42' at the two Retail units adjacent to 1st Street.
- Street Parking adjacent to site
- Public Parking Garages at North side and Northwest area of property
- Ceiling Heights range from 16' to 25'



Artist's Rendering

POINTS OF INTEREST

RESTAURANTS & BARS

1. 400 Beach Seafood and Taphouse
2. BellaBrava
3. Bodega
4. Cassis
5. Datz
6. Doc Ford's Rum Bar & Grill
7. Driftwood Café
8. Iberian Rooster
9. Ichicoro Ane
10. Il Ritorno
11. Kahwa Coffee
12. Mandarin Hide
13. Paul's Landing
14. Pier Teaki
15. Red Mesa Cantina
16. Sea Salt
17. Teak
18. The Canopy
19. The Mill

ENTERTAINMENT

1. Al Lang Stadium
2. AMC Sundial 20
3. Mahaffey Theater
4. Palladium Theater
5. Tropicana Field

ARTS & HISTORICAL

1. Chihuly Collection
2. Morean Arts Center
3. Museum of Fine Arts
4. Museum of the American Arts and Crafts Movement
5. St. Petersburg Museum of History
6. The Dalí
7. The James Museum of Western & Wildlife Art

AIRPORT

1. Albert Whitted Airport

MEDICAL

1. St. Anthony's Hospital

RECREATION

1. North Straub Park
2. St. Petersburg Municipal Marina
3. The Pier
4. Vinoy Marina
5. Vinoy Park

SHOPPING

1. Publix Super Market
2. Sundial



1ST STREET SOUTH



2ND STREET SOUTH

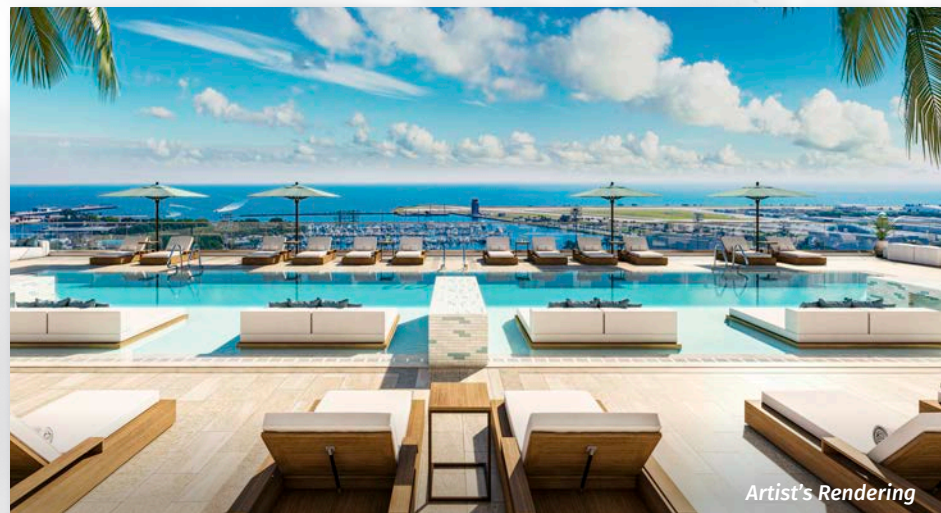

Artist's Rendering



Artist's Rendering



Artist's Rendering



SALTAIRE

ST. PETERSBURG

FOR MORE INFORMATION CONTACT:

Brian Van Slyke, The Kolter Group
O: 727-474-0931 | BVanSlyke@kolter.com

Broker Participation is welcomed and encouraged. ORAL REPRESENTATIONS CANNOT BE RELIED UPON AS CORRECTLY STATING REPRESENTATIONS OF THE SELLER. FOR CORRECT REPRESENTATIONS, MAKE REFERENCE TO THIS BROCHURE AND TO THE DOCUMENTS REQUIRED BY SECTION 718.503, FLORIDA STATUTES. TO BE FURNISHED BY A SELLER TO A BUYER OR LESSEE. Prices, terms and availability are subject to change at any time without notice. Actual improvements, including furnishings, fixtures, recreational facilities and amenities, may vary from those shown and views may not be available from all units. This is not an offer to sell or solicitation of offers to buy the condominium units in states where such offer or solicitation requires prior qualification. For New York Residents: THE COMPLETE OFFERING TERMS ARE IN A CPS-12 APPLICATION AVAILABLE FROM THE OFFER OR FILE NO.: CPS20-0032. K T St Pete Bayfront LLC, 301 1st Street South, St. Petersburg, Florida 33701. This advertisement is a solicitation for the sale of condominium units in Saltire Condominium: NJ Registration # 20-04-0010.



All dimensions are approximate. The floorplan is subject to change without notice. The seller reserves the absolute right, in its sole judgement and discretion, to substitute appliances, materials, fixtures and equipment of equal or greater value for those specified. There are various methods of calculating the total square footage of a condominium unit, and depending on the method of calculation, the quoted square footage of a condominium unit may vary more than a normal amount. The total condominium square footages as shown in this brochure are based on the "Architectural Method" of measurement which measures the exterior perimeter of the condominium unit, and also includes interior columns and fifty percent of demising walls. The method for calculating residential square footage used in marketing materials is different than the method used for calculating residential square footage in the condominium documents. Please see the Declaration of Condominium for more information. The model shown includes options and upgrades that are not a part of a base residence pricing.

